

# HYDRON

## HYDROGEN BUS M3 - CLASS I



### VERSION AND DOORS

#### 2 DOORS

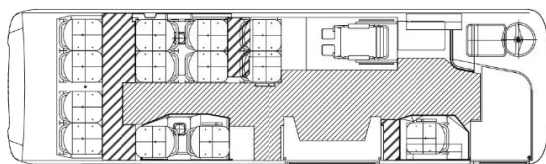

No. of seats	13 + 1 wheelchair + 1 driver
No. of standing places	30 with wheelchair, 34 without wheelchair
Total no. of passengers	45 with wheelchair, 48 without wheelchair
Floor	Low throughout

### DIMENSIONS AND WEIGHT

Vehicle length	8.000 mm	Front overhang angle	10°
Vehicle width	2.200 mm	Rear overhang angle	9°
Vehicle external height	3.250 mm	Front track	1.850 mm (Single wheels)
Wheelbase	3.700 mm	Rear track	1.670 mm (Twin wheels)
Front overhang	1.870 mm	Door threshold height	340 mm (Third door with 120mm step)
Rear overhang	2.430 mm	Maximum Gross Weight	12.000 kg
Turning radius	14.850 mm		



## **TRACTION MOTOR**

Motor	PEM (Permanent Magnet Motor)
Power	230 kW
Maximum speed	70 km/h
Maximum gradient:	> 16 %

## **FRAME**

Frame	Steel unibody, stainless steel wheel arches
-------	---

## **TRACTION BATTERIES**

Batteries	LiFePO4, 175 kWh
Hydrogen	3 tanks 3.6 kg each, 350 bar, 194 kWh
Charging socket	Type CCS2 on the rear left side
Hydrogen refuelling	Nozzle with SAE J2600 profile, rear right side
Range in Km	> 400 km (without air conditioning)

## **DOORS**

Front door	Electric, 1 internal pivot sliding door, width 730 mm
Central door	Electric, 1 sliding door, width 1180 mm

## **RAMP**

Wheelchair ramp	Manual folding ramp on central door, load 350 kg
-----------------	--

## **DRIVER'S SEAT**

Driver dashboard	Colour display
Driver's seat	Pneumatic seat suspension
External rearview mirrors	Rearview mirrors equipped with cameras
Internal rearview mirrors	Rectangular front mirror, Round mirror near the door

## **AIR CONDITIONING**

Driver area	3 kW independent AC, heating 3 kW
Passenger area	7 kW independent AC, heating 7 kW
Heating radiators	Convactor heaters